

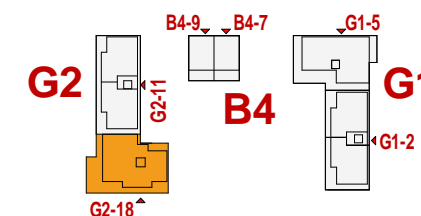

Friedrichspark
Am Rande der Südstadt



| Penthaus | | WG G2-18-10 | |
|---------------------|-------------------------------------|----------------------------|----------------|
| 5 Zimmer Wohnung | | | |
| Wohnen/Essen/Kochen | | 60,69m ² | |
| Schlafen | | 21,50m ² | |
| Zimmer 1 | | 11,79m ² | |
| Zimmer 2 | | 12,75m ² | |
| Zimmer 3 | | 10,57m ² | |
| Bad | | 10,35m ² | |
| Du/Wc | | 6,41m ² | |
| Abstellraum | | 2,72m ² | |
| Flur | | 12,84m ² | |
| Terrasse 1 | 51,74m ² Grundfl. zu 1/2 | 25,87m ² | |
| Terrasse 2 | 8,32m ² Grundfl. zu 1/2 | 4,16m ² | |
| Terrasse 3 | 11,00m ² Grundfl. zu 1/2 | 5,50m ² | |
| Wohnfläche | | 185,15m² | |
| M 1:125 | | | Rs.\26.07.2017 |